



Product Installation Guide

Crystal Pure CPURE

Can be fitted into any existing hole up to a max of 35 mm diameter and up to 40 mm thickness.

If a new hole is required, the tap can be fitted into a minimum 12 mm diameter hole.

Take the tap and tap base (including the large black rubber washer which should be supplied inside the tap base) and insert into the hole of the mounting surface.

Ensure the tap is in the desired orientation.

On the underside of the mounting surface place the large black rubber washer followed by the large steel washer over the thread before using the hex nut to fix the tap firmly into place.

The push fit pipe connector will facilitate connection to 1/4" tubing (supplied with filter).

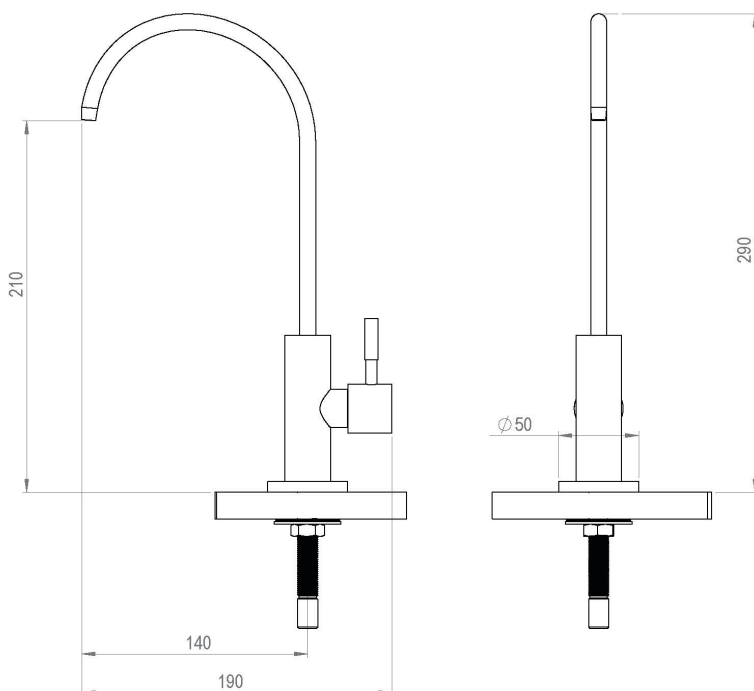
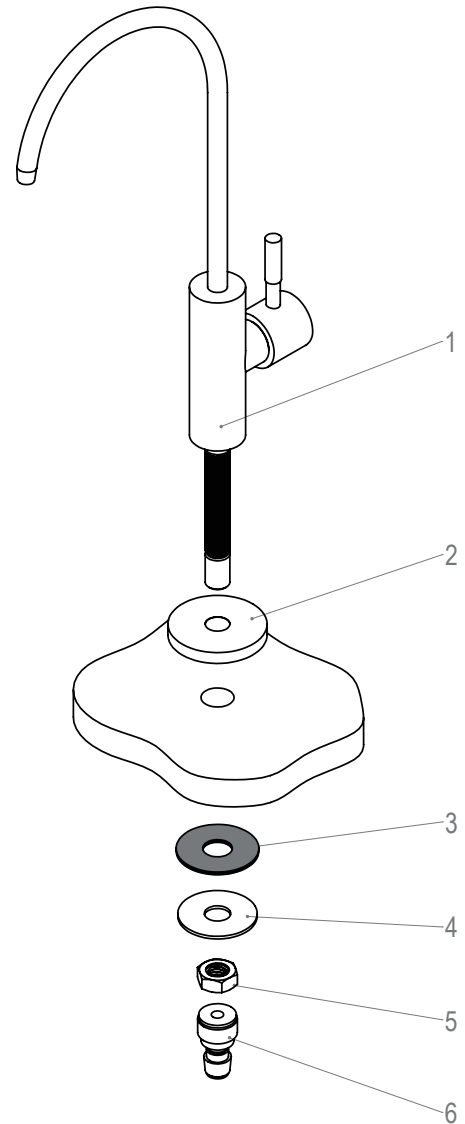

- 1 Tap body
- 2 Tap base inc. large black rubber washer
- 3 Large black rubber washer
- 4 Large steel washer
- 5 Hex nut
- 6 Push fit pipe connector